

# ACRO BASE



## ***OPERATING MANUAL***

### ***2015 Series***

Dear Customers,

***Thank you for choosing AVA Sport equipment!***

The Acro Base is the harness that raises whole new standards regarding safety in paragliding. Integrating the usual under the seat rescue and new main container on the back of the harness – for the square rescue. More to this is the cutaway system together with the Rescue Static Line ( RSL ) and the whole this system makes all your troubles go away in case of a malfunction. For Acro Base Harness we use elements from skydiving equipment, that proven as most reliable and safety in the sport. The fresh overall look and the funky colors are just additional perks of this amazing harness, created to comfort you in your adrenaline rush.

The basic Acro Base harness comes with 3-Ring System, Free bag with RSL for the square rescue parachute, with all the handles and one pair of karabiners. You can ask us or your AVA dealer for extras such as : custom embroidery, cutaway system for some bombs, speed bar detachments, speedbar, soft links and backpack.

## **!!! W A R N I N G S !!!**

Please read this operating manual carefully. Paragliding is an activity requiring, skills, specific knowledge and sound judgement. Be safe by learning in certified schools, subscribe and obtain an adequate insurance policy as well as a flying license while always making sure your flying skills are up to the task and weather conditions. Given the high risk of acro flying and the consequences of this kind of flying you must be responsible for your decisions and activities.

Acro Base harness is designed to provide fast, easy and safe opening of your controlled rescue canopy, which you can use to land safely on a desire location.

The Acro Base harness was designed for the paragliding activity only. It is NOT a Base jumping or a freefall harness. The PILOT is responsible for the proper use of the harness.

It's recommended the Cut Away System to be used only in emergency situations.

Because of the use of many different rescue parachutes and their opening time difference, Cut Away System needs min. 150 m to be safely. Under this minimum it's recommended to use the second rescue parachute located under the seat.

In case of an accidental fall into the wing, the only recourse of action would be to deploy the classic reserve parachute located under the seat. The Cut Away System cannot be used in this situation.

Do not leave your hand(s) in the risers or in the toggles during the cut away process.

Using other karabiners, different than the provided by the manufacturer, is not recommended and pilot's responsibility.

This Acro Base system is not working with the standard speed systems. To use a speed system on Acro Base Harness, you need to set up the manufacturer speed bar release system.

Towing with Acro Base - the harness does not have special point for towing. If you use it for towing you need to attach the towing system so, that cut away system ( 3-Ring and cut away handle) stay away and clear from the towing mechanism.

This is essential that you carry a helmet, suitable boots and clothing. Carrying a reserve parachute suitable for your weight and correctly connected to your harness is also very important.

When not using your harness, store it inside your paragliding backpack, in a dry, cool and clean place, protected from UV exposure. If your harness is wet, please dry it thoroughly before storing.

During transport, protect the harness from any mechanical or UV deterioration (use a bag).

After reading this manual, we highly recommend you to check your harness by hanging in it before flying.

The proper use, compliance status and storage of Acro Base Harness together with the Cut Away System is Pilot's responsibility and can be helpful for your harness life.

## **MANDATORY CHECKS**

The rescue canopy ( main) must be repacked min. every 6 months or after water landing.

The 3-Ring System must be checked every month.

The cut away cable must be pulled out, checked and cleaned with alcohol monthly, or after water landing and system landings on the sand

Hosing negotiability must be checked every month or after water landing and system landings on the sand.

The RSL and Free bag must be checked regularly for damages and especially after emergency cut away.

The second rescue under the seat must be repacked as per manufacturer manual or after water landing.

## **DALY PRE-FLIGHT CHECK**

1. Check if the karabiners are good tighten
2. Check if the RSL is attached to the karabiner
3. Check the black cable pins on the RLS
4. Check if the cut away handle is on it's place.
5. Check if the yellow cut away cables locked the right and left loops
6. Check the loop condition
7. Check the handle and the cable pin of the second rescue
8. Check all buckles

If you are not sure how to set up your harness, you have any question do not hesitate to contact us for support [info@avasportcentral.com](mailto:info@avasportcentral.com)

**Description of the Acro Base Harness**



**Spear Part for Acro Base Harness**

Cut away Loops



Cut away handles



Second rescue handle



Elastic for Free Bag



Karabiners



Free bag



Speed bar release system set



Soft link connections set



## 1. Cut Away System

Acro Base Harness use the most popular and safety system from skydiving - the 3-Ring System and Rescue Static Line (RSL). The Acro Base Cut Away System includes a free bag with Rescue Static line (RSL), loops, karabiners, cut away handle ( in two different options).



### 1.1. Cut away handle set up

Pass the both ends of the cut away handle trough the small red loop on inner side of the main strap (step 1). Pull the whole cable till the handle comes to the strap (step 2). Plug in the short end of the cutaway cable into the upper hosing and pull it (step 3 and 4). Plug in the longer cutaway cable into the bottom hosing and pull it (step 5 and 6). Cover the strap with the cloth piece and stick the Velcro (step 7 and 8).

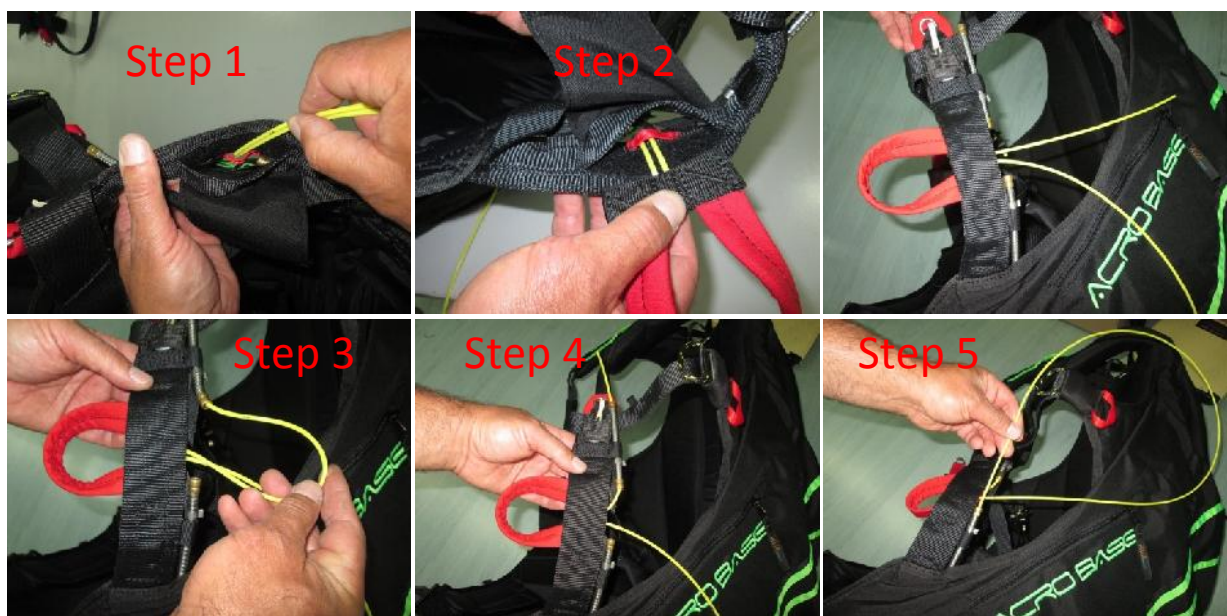



**!!! CHECK IF THE CUT AWAY CABLE IS PASSING THROUGH BOTH HOUSING !!!**



### 1.2. The 3-ring System set up

Using a line or cord, assemble the small loop. Plug in it and pull it, so that the small ring goes inside under the belt. Make this on both sides of the harness.



Use a packing line to pass it through the loop. Pass the big ring through the karabiner first and after that the small ring through the big one.

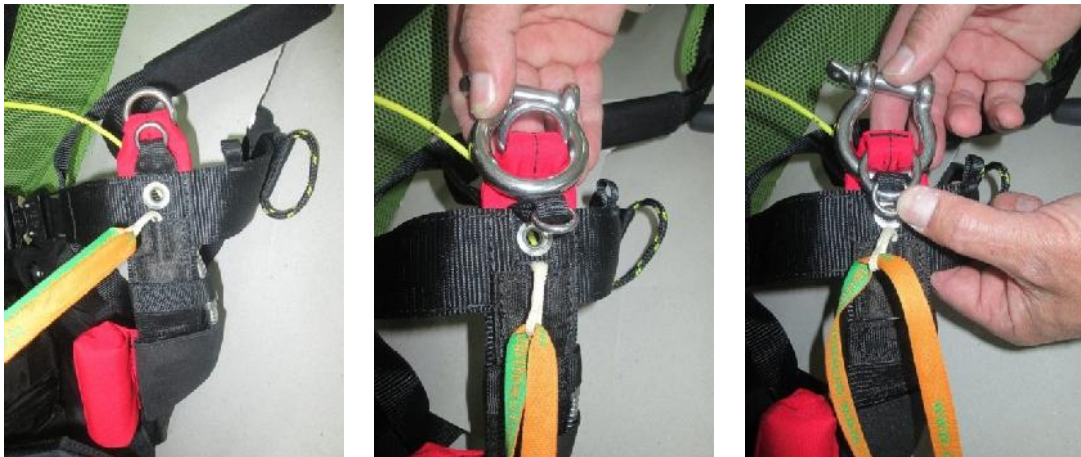

After that pass the packing line, from front to back, through the loop, the small ring and the grommet.

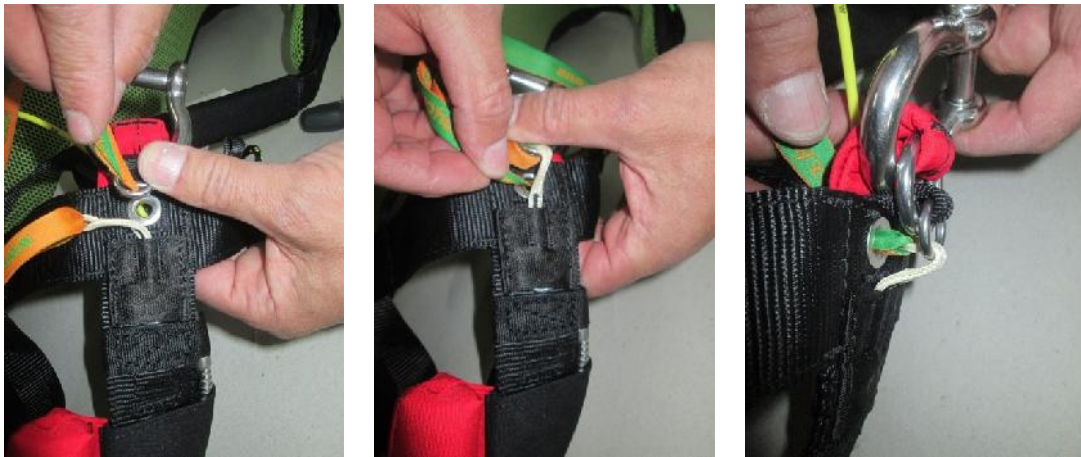

The Loop must be on the back side of the grommet. Lock with the cutaway cable and insert the cable end into the chest strap.

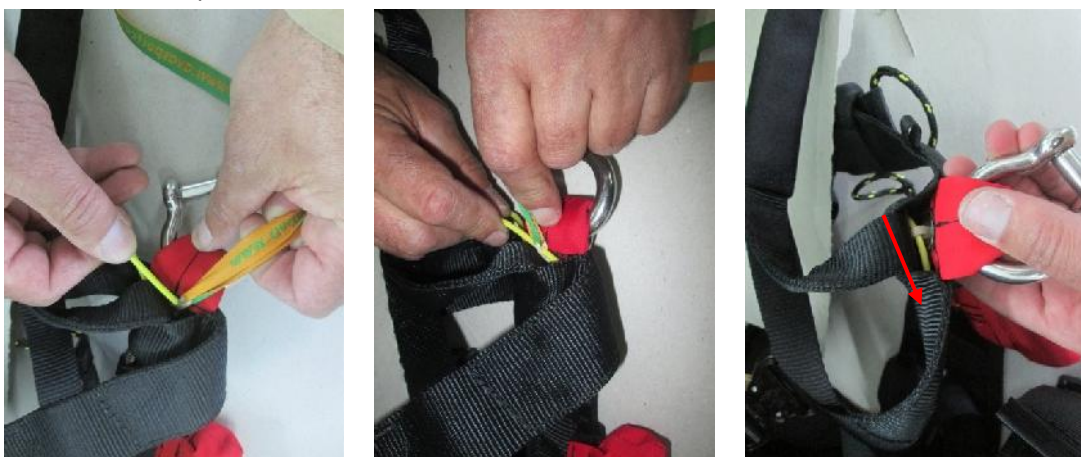

**!!! DON'T FORGET TO MAKE THIS ON BOTH SIDES OF THE HARNESS  
TAKE OUT THE PACKING LINE!!!**



After you are ready with the set up of the Cut Away handle, hang up your harness somewhere to test how the Cut Away System is working. And make some exercise for cut away.

***We highly recommend every pilot, no matter what experience it has, to try the correct work of the cut away system on the ground.***

***Compulsory is every pilot no matter what experience it has, to make one training cut away on the ground, at least once every two months, or after each cut away/ disassemble of the Cut Away System.***

We offer you a simple system for Cut Away System test on the ground. Everyone can make it at home.

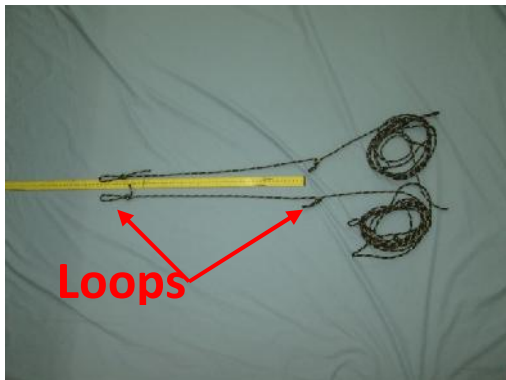

Take 2 long enough ropes and tie 2 loops (about 50 cm one of each other). Hang the other end of the rope tie on your home beam or on the tree in your garden (about 50-60 cm above the ground).

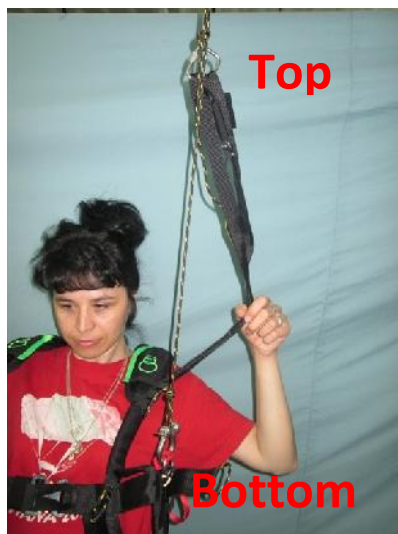

Attach the bottom end to the karabiners and at the top loop attach the rescue risers.

Pull the cut away handle sharply to the front till your hand is full straight.



***After you finish with the ground test of the Cut Away System and at least one cut away exercise, you can go for assemble your rescue parachute. If you cannot assemble and pack your rescue parachute, please contact an authorized competent skydiver rigger.***

## 2. Rescue canopy set up

Hang your rescue with the leading edge down and check all the lines. There should be no twisted, damaged or broken lines.

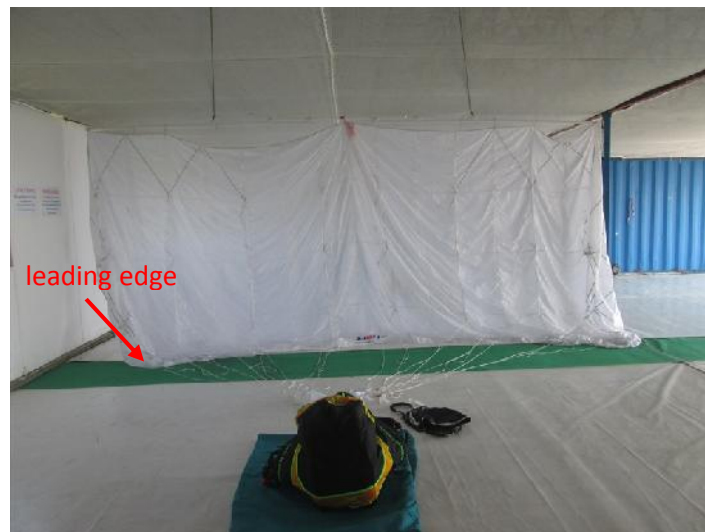

After you check all the canopy lines, lay down the harness and sort out the main risers.

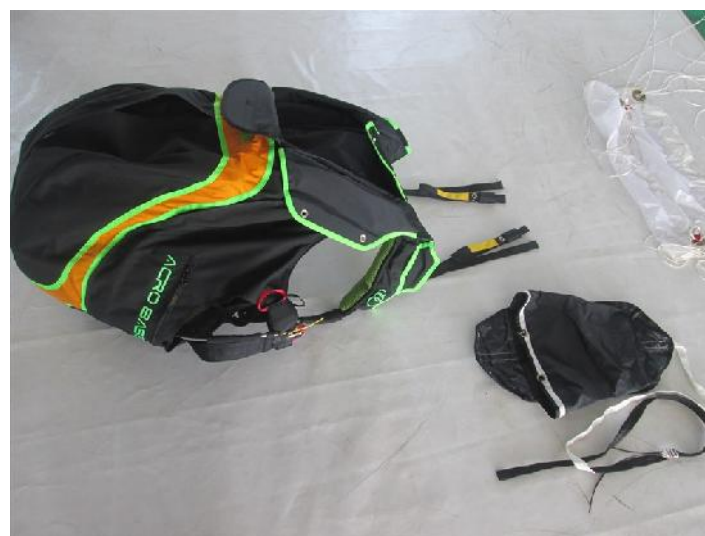

Connect the Left back rescue riser with the canopy lines via "soft link" connection or Maillon Rapide® according to the following pictures bellow:

Attachment with **SOFT LINK**

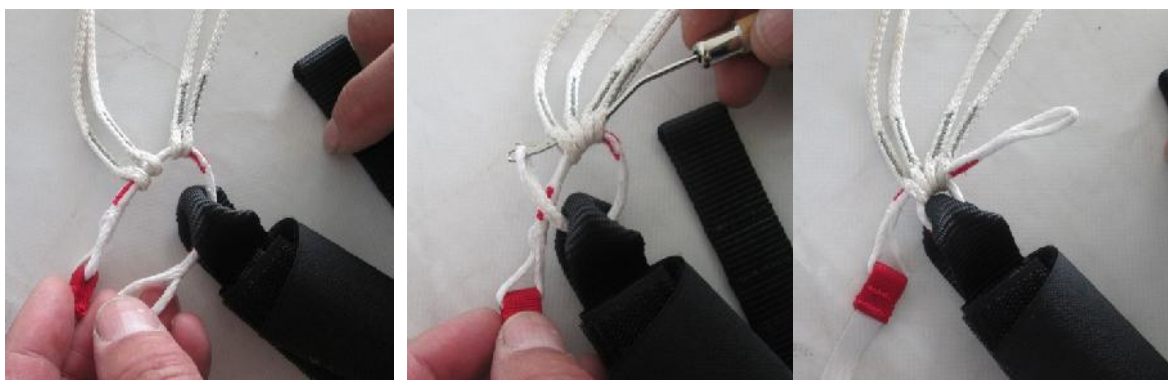

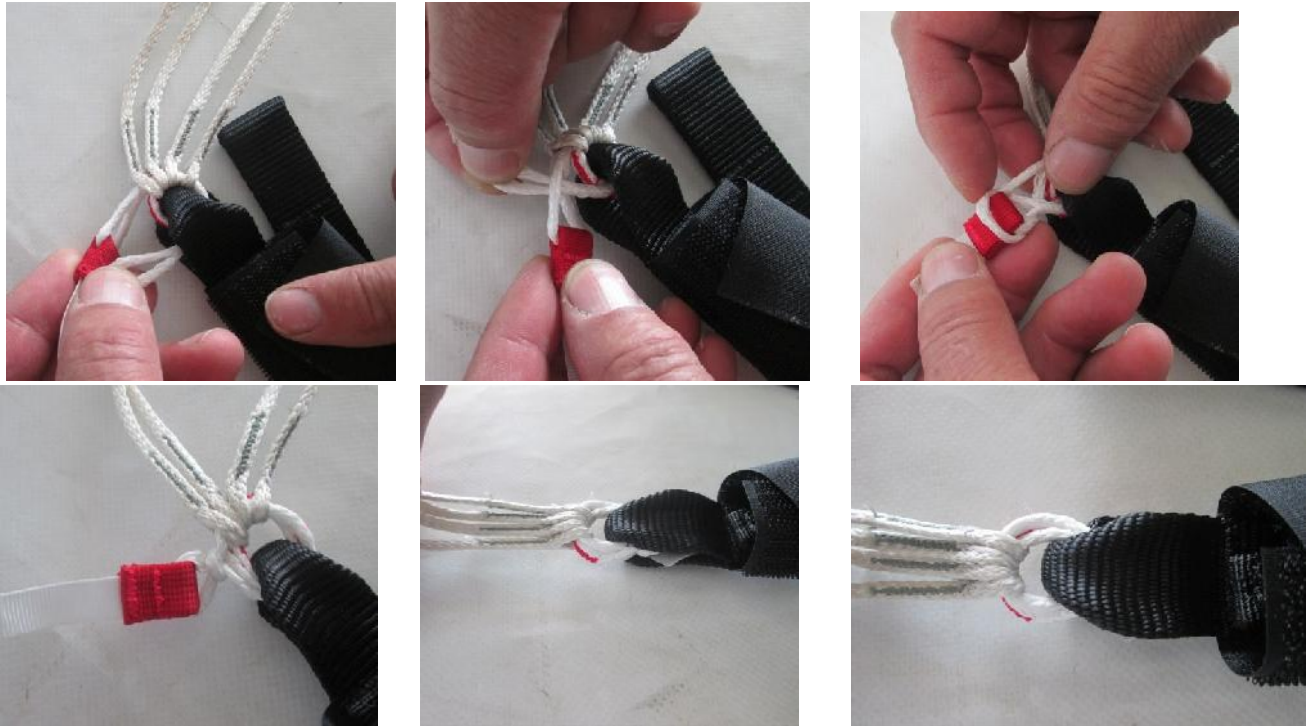

Assemble of the toggles

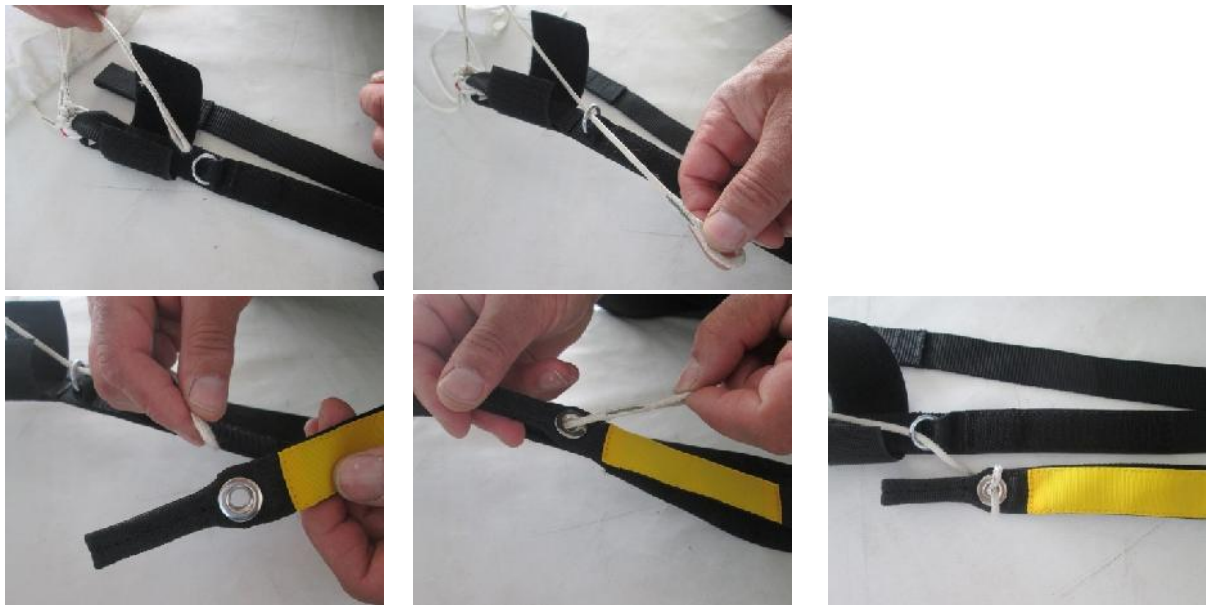

Attachment of the left front riser is shown on the pictures bellow.





After you finish with the attachment of the left back riser, left toggle and left front riser, make the same steps for the right risers and right toggle.

If you attach your canopy with Maillon Rapide® just connect the lines and rise via Rapide



At the end check once again, if your canopy and the harness are correctly attached together.



After you finish with the attachment of the rescue canopy, **PACK YOUR RESCUE CANOPY IN ACCORDANCE WITH THE RESCUE CANOPY MANUFACTURER MANUAL!**

Prepare the free bag and when the canopy is ready put it inside the free bag. Fold the canopy lines, pass them through the elastic as shown on the pictures below:



Now turn the free bag, fold the lines inside the free bag pocket and stick the velcro on both sides. **CHECK IF THE LINES ARE NOT BONDED WITH THE VELCRO!**



Now turn the free bag and put it in to the harness container with the line pocket down.



Fold the Rescue Static Line (RSL) on to the free bag.



Take 2 packing lines and close the rescue container covers as shown on the pictures below. At first close Top flap (T1) with the right site top grommet (T2) and after that the bottom cover (B1) with the right site bottom grommet (B2). After that go through the left site cover top grommet (T3) and then through left site bottom grommet (B3).



Secure top loop with the shorter cable pin

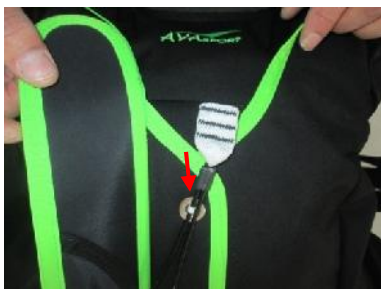

Secure bottom loop with the longer cable pin and insert the cable into the small pocket



**!!! DON'T FORGET TO REMOVE THE PACKING LINES !!!**

Stick the RSL with the Velcro and after that close it with the cover on left and right site as shown:



Shape the pin cable cover



Close the shoulder straps with the magnets.

**NOTE: magnets should be placed inside the magnet pocket.**



### 3. Set Up of the rescue parachute under the seat (round canopy)

***Pack your second rescue parachute as per manufacturer manual.***

Put it into the container and connect the handle on the side. After that, connect the rescue belt with the risers.



Put the rescue in to the harness container and using a packing line, close the container covers as shown on the pictures below. Don't forget to secure the loops with the black cables and at the end to remove the packing line.

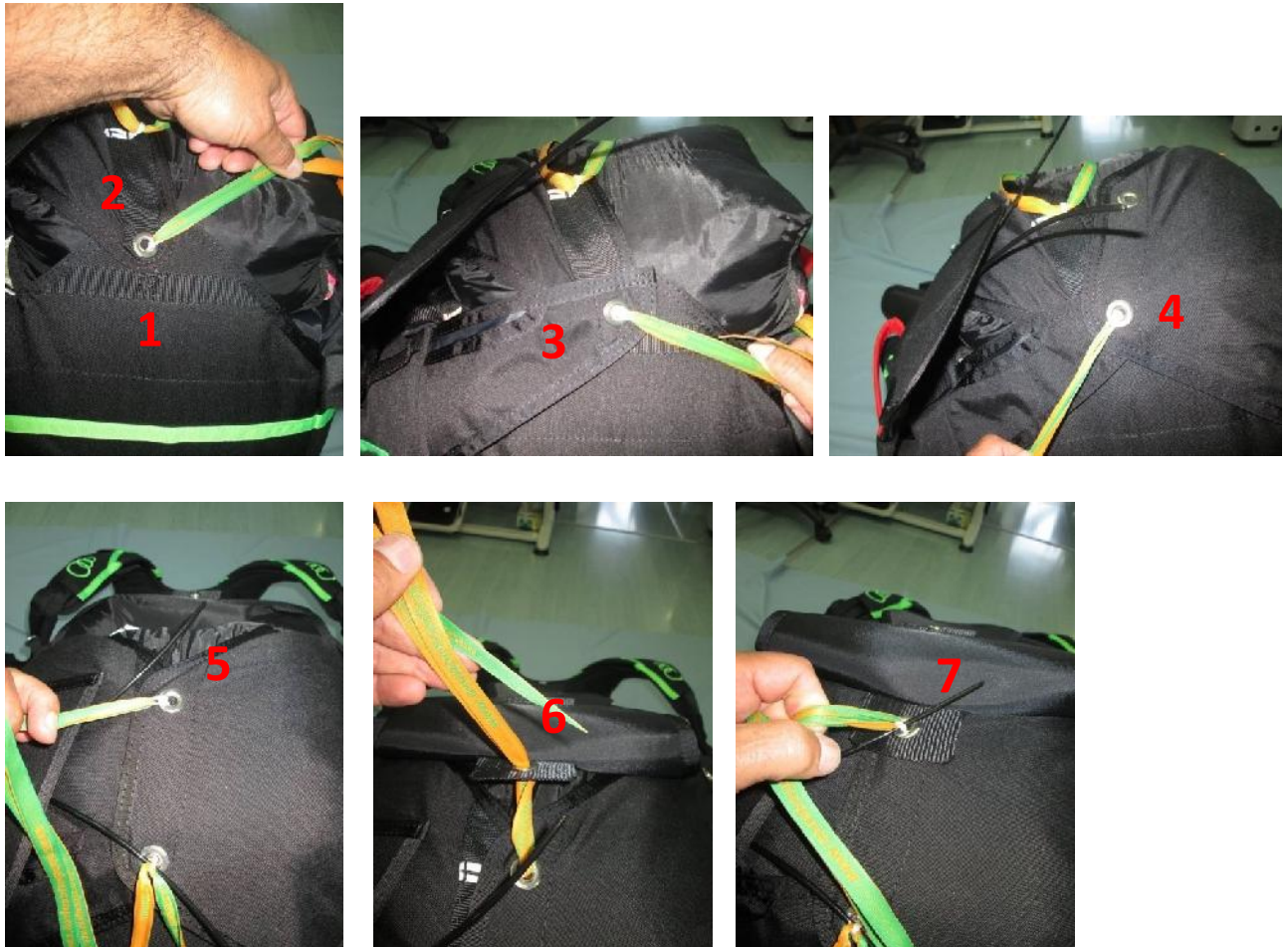





*After you finish with assemble of the both rescues you can attach your paraglider.*

#### **4. Main wing attachment**

After you sit in your harness and adjust the shoulder straps, stick with Velcro the RLS to the neoprene cover as shown on the picture:



Attach the left riser of your paraglider to the left karabiner and tighten it. Make the same with the right paraglider riser and attach the RSL via Maillon Rapide<sup>®</sup> to the karabiner.



**!!! Your harness is ready !!!**



**!!! ENJOY YOUR FLIGHT, AND DON`T FORGET THE  
MOST IMPORTANT - THE SAFETY !!!**

*AVA Sport Ltd  
Zahari Stoianov str. 44  
3400-Montana  
BULGARIA  
avasport@avasportcentral.com  
www.avasportcentral.com*